

MITUS

121SA

PROCESSED ACTIVE
SUBWOOFER

APPLICATIONS

- Permanent installations in:
Theatres, Concert Halls, Clubs, Places of Worship,
Conference Rooms, Indoor Sports, Arenas & Stadiums
- Sound reinforcement for live events:
Touring, Bands, Orchestras

FEATURES

- 18mm / 0.70" birch plywood enclosure
- 1200W RMS class D amplifier
- 530mm/21" custom B&C neodymium magnet with
115mm/4.5" coil
- Frequency response 29Hz - 100Hz
- Input panel with XLR in & link, volume, preset, delay,
phase, GND lift
- SPL capability 137dB
- 4 swivel mount casters 3.15" on request
- M20 stand socket
- Completely Manufactured in Italy



PRODUCT DESCRIPTION

The FBT MITUS 121SA, 21" large vented bass reflex subwoofer is the perfect low-frequency extension for the MITUS range and the ideal companion for the FBT MITUS 206LA line array for ground stack applications with optional metal base. The FBT MITUS 121SA shall meet the following performance criteria: Frequency response of 29Hz to 100Hz, Maximum SPL of 137dB peak, Class D amplifier 1200W RMS. The FBT MITUS 121SA provides a DSP with 8 presets-cardioid and infra configurations. The FBT MITUS 121SA feature 0.70" Baltic birch plywood construction covered in a scratch resistant black paint with M20 top-mounted stand adapter and six FBT design aluminium handles. The control panel provides XLR in & link, volume control, preset, delay, phase 0°-180°, GND lift.

ELECTRICAL PERFORMANCE

| | |
|----------------------------------|---|
| System Type: | vented bass reflex |
| Built-in Amplifier* | cont: 800W RMS max: 1200W RMS peak: 2400W RMS |
| Frequency Response @ -6dB | 29Hz - 100Hz |
| Input Impedance | 22k Ohm |
| Maximum SPL (continuous/peak) ** | 133dB / 137dB |
| Dispersion | omnidirectional |
| Crossover Frequency | preset dependant |
| AC Power Requirement | 640 VA |

PHYSICAL

| | |
|-----------------------------|--|
| Low Frequency Woofer | 1 x 21" - 4.5" coil |
| Input Connectors | XLR with loop |
| Net Dimensions (WxHxD) | 23.2" x 30.7" x 29.9" 590 x 780 x 760mm |
| Shipping Dimensions (WxHxD) | 31.49" x 37" x 27.55" 700 x 940 x 800mm |
| Net Weight | 127.8 lbs / 58 kg |
| Shipping Weight | 146.6 lbs x 66.5 kg |
| Enclosure Material | birch plywood |

* CONT: 500mS, RMS power on nominal speaker impedance
MAX: 2mS burst, RMS power on nominal speaker impedance
MAX PEAK: based on max peak output voltage and nominal speaker impedance

** CONT. SPL: half space, based on continuous power amp rating and LF transducer average sensitivity data, 125mS time average
PEAK SPL: half space, based on max peak power amp rating and system peak sensitivity, 10mS time average



FBT Elettronica s.p.a. - Via Paolo Soprani 1-Zona Ind.le Squartabue - 62019 RECANATI - ITALY
Tel. 071 750591 - Fax 071 7505920 - e.mail: info@fbt.it - www.fbt.it

MITUS

121SA

PROCESSED ACTIVE
SUBWOOFER

DIAGRAMS

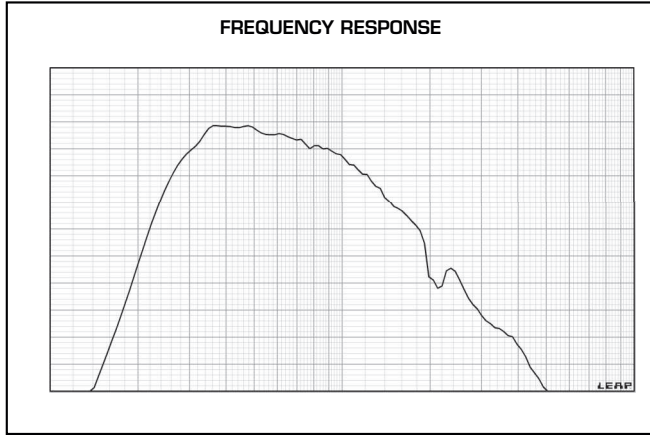

AMPLIFIER MODULE

The FBT MITUS 121SA provides a high efficiency class D power amplifier module with switching power supply enclosed in a die-cast aluminium chassis.

This provides maximum protection of the electronics from dust or dirt, prevents air loss through the input control panel that can cause fastidious noise, and it maximizes heat dissipation avoiding the use of a fan to cool the circuitry.

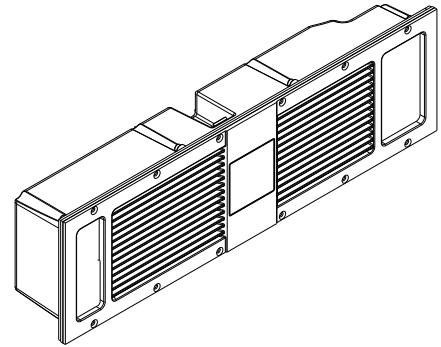

CONNECTION PANEL

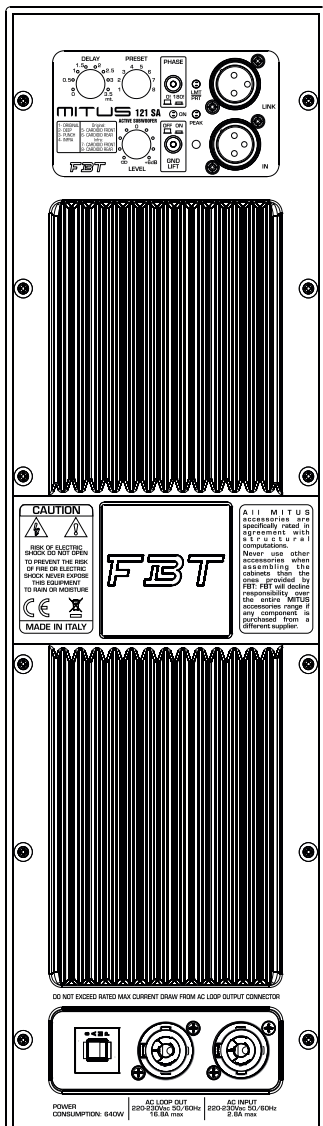

DIMENSION DRAWING

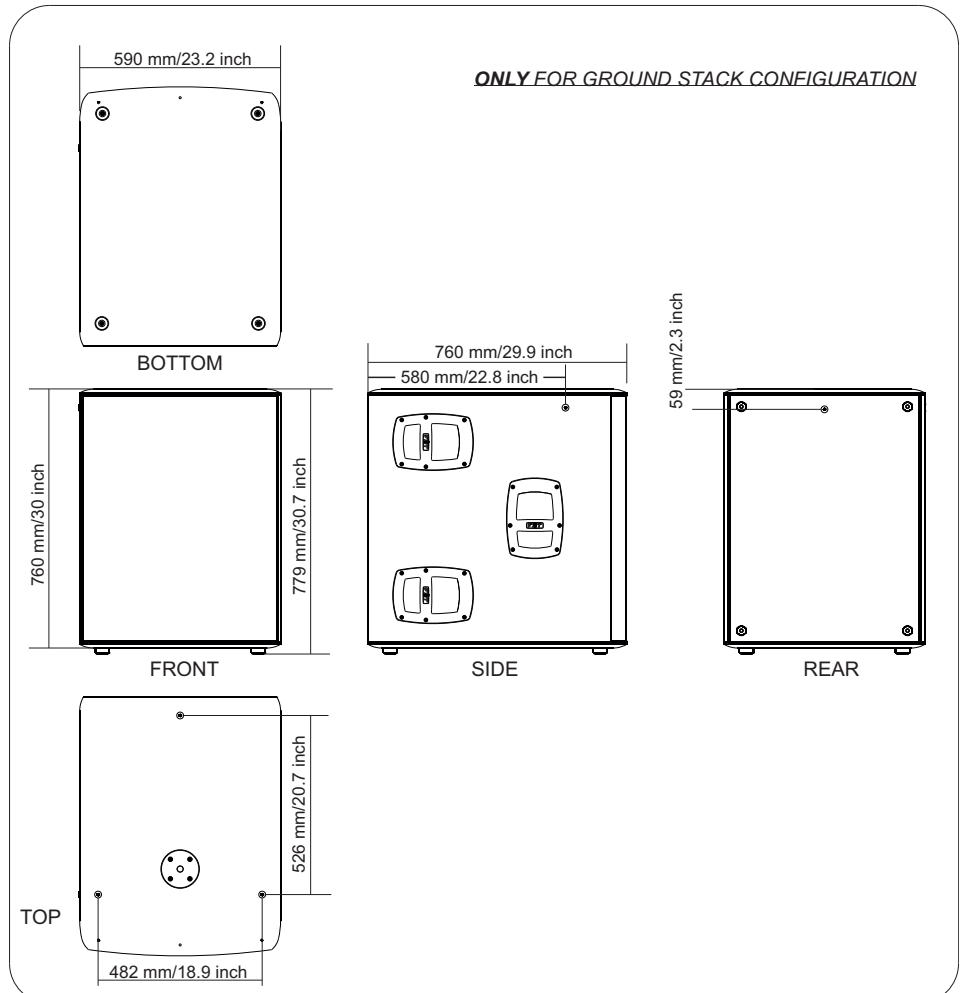

MITUS

121SA

PROCESSED ACTIVE
SUBWOOFER

ACCESSORIES

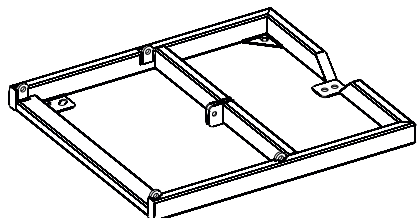

MT B206
Metal base to ground
MITUS 206LA array or stack
on MITUS 121SA

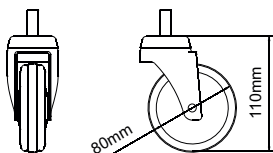

Swivel wheel for easy
transport when the metal base
lays on the ground

BOX 62BK
Adjustable, for sub-satellite
speaker connection with
safety locking device
Ø35mm / 1.38"



OPTIONAL WHEELS

